

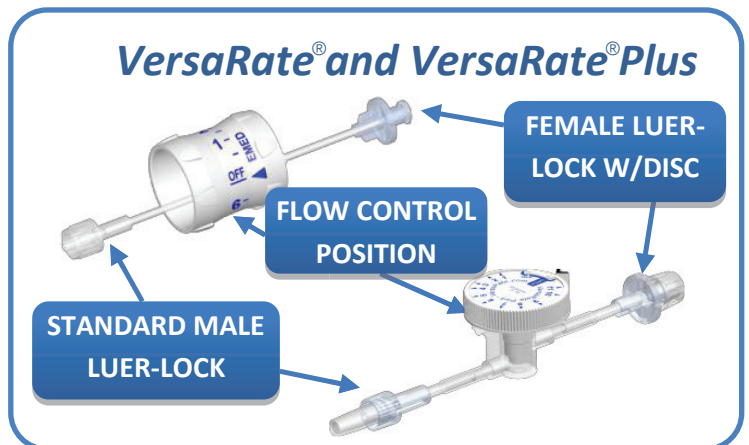

The SClg60 Infuser is a reusable constant pressure mechanical, non-electronic ambulatory infusion pump intended for use in the home or hospital environment. It is the first mechanical syringe infusion system cleared by the FDA specifically for infusion of Immunoglobulin G (IgG) into subcutaneous tissue.

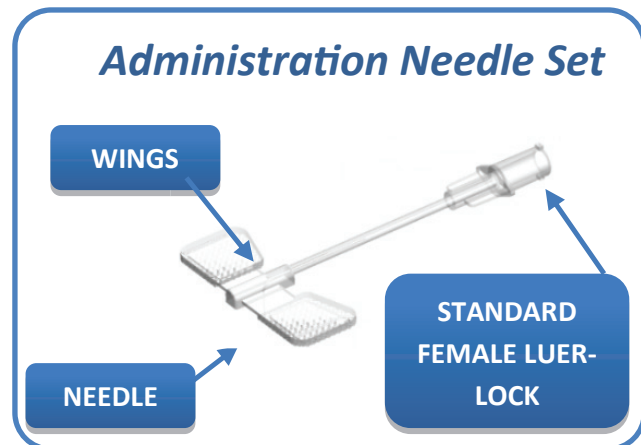

Reference EMED Document Number AS-0010021 for the complete user manual.

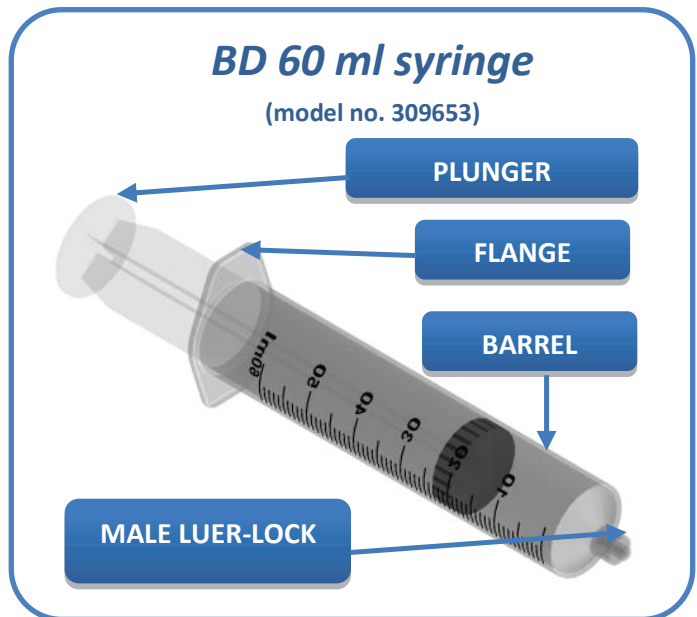
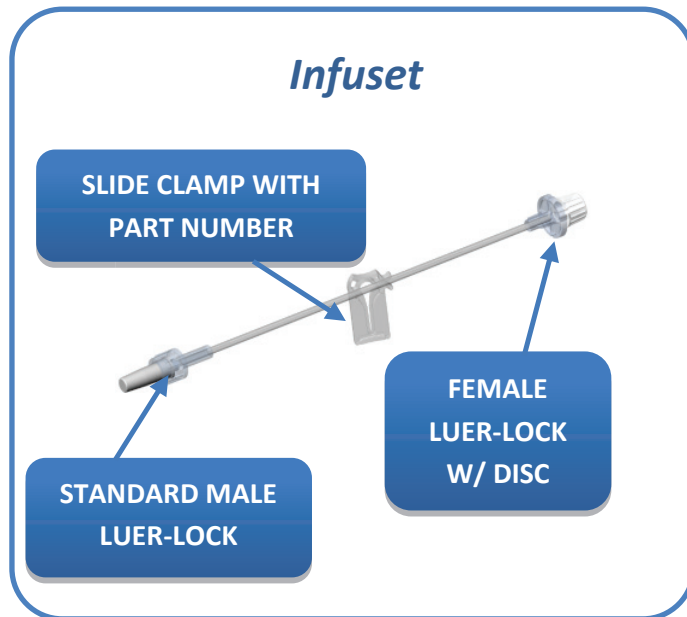

Prepare the Work Area

01. Wash and dry hands thoroughly before handling any supplies, and wear gloves if instructed by your healthcare professional.
02. Create a clean work area by wiping the entire surface of this mat with a small amount of disinfectant soap and water or alcohol.
03. Let the surface air-dry and clean your work area again if it becomes contaminated during use.



Gather Equipment

04. Refer to the steps in the instructions for use, user manuals and drug prescribing information to perform therapy treatment.
05. Make sure you have all the necessary supplies gathered in your work area prior to beginning. Generally, these supplies include:

- | | |
|------------------------------------------|--------------------------------------------------------------------------------------|
| 1. SClg60 Infuser | 5. BD 60-mL Syringe (model no. 309653) |
| 2. Prescribed Immune Globulin Medication | 6. Patient Administration Set |
| 3. Needle or Spike | 7. Site Dressing |
| 4. Alcohol Pads | 8. Preferred Flow Rate Control Infusion Set (Infuset, VersaRate® or VersaRate® Plus) |

Have a sharps container nearby for proper disposal.

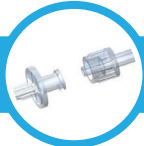

Prime and Prepare Needle Sets

06. Connect flow rate control infusion set to syringe and patient needle set.



07. Prime and close flow rate control set and patient needle set per healthcare provider instructions.



08. Refer to healthcare provider instructions to insert needle set to patient.



Prepare Infusion Pump

09. Open the SClg60 Infuser by turning the handle counterclockwise until it stops.



10. Ensure that the flow rate control infusion set is clamped for Infusets or is in the 'OFF' position for VersaRate® or VersaRate® Plus.



11. Load & lock the syringe into the SClg60 Infuser by inserting the syringe plunger & rotating the syringe clockwise until it stops.

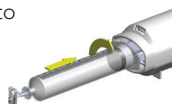

12. Verify the syringe flange is in the window of the SClg60 Infuser to confirm the syringe is properly locked in place.



13. Close the SClg60 Infuser by turning the handle clockwise until the base of the handle touches the body of the pump.



Infuse

14. Complete Infusion as instructed by your health care provider. Refer to the steps in the instructions for use, user manuals and drug prescribing information to perform therapy treatment.
15. Refer to flow rate calculators at www.versarate.com to estimate expected flow rates.



Completion

16. When infusions are complete, open the SClg60 Infuser by rotating the handle counterclockwise until it stops, then unlock and remove the syringe by turning it counterclockwise and pulling it out. Dispose of needle set, syringes and flow rate control infusion set (Infuset, VersaRate®, or VersaRate® Plus) in appropriate waste or sharps containers.